

Agenda 03/01/17

- How to create an image file using Acronis True Image (and a built in alternative)
- How to clone a disk using Acronis True Image (or EZ Gig IV)

How to create a disk image

- What is it?
- A bit by bit map of the drive that can be restored to another drive resulting in a clone
- Why?
- Quick way to restore PC in the case of:
 - Boot disk failure
 - OS upgrade gone bad
 - Dislike of new OS, etc.
- How?
- Acronis True Image
 - Cost \$49.99 / 1 PC; \$79.99 / 3 PC; \$99.99 / 5 PC
 - Cheaper at Amazon \$28.76 / 1 PC ; \$44.60 / 3 PC

Select path for image file

The screenshot shows the Acronis True Image 2017 interface. On the left is a dark blue sidebar with navigation options: BACKUP, ARCHIVE, SYNC, TOOLS, DASHBOARD, ACCOUNT, SETTINGS, and HELP. The main area is titled 'This computer' and shows a selected backup path: 'Entire PC (BOB-SAMSUNG)' with a sub-path 'E:\Bob-Samsung IMG10\'. At the top right, summary statistics are displayed: 'Last backup today at 11:44 AM', 'Next backup Not scheduled', and 'Total size 147.7 GB'. The central part of the interface features two large boxes representing the backup source and destination. The left box is labeled 'Entire PC' with a laptop icon and '202.6 GB of data selected'. The right box is labeled 'External drive' with a USB drive icon and '215.6 GB of 931.5 GB free' and the path 'E:\Bob-Samsung IMG10\'. A green checkmark in a circle is positioned between the two boxes, indicating a successful connection. At the bottom right, there is a prominent green 'Back up now' button. A red arrow points from the text 'Then click "Back up now"' below the screenshot to this button. Other buttons at the bottom include 'Options', 'Recover PC', and 'Recover files'.

Then click “Back up now”

To restore a crashed PC, you must have prepared a rescue disk

- This option is found under the tools icon:

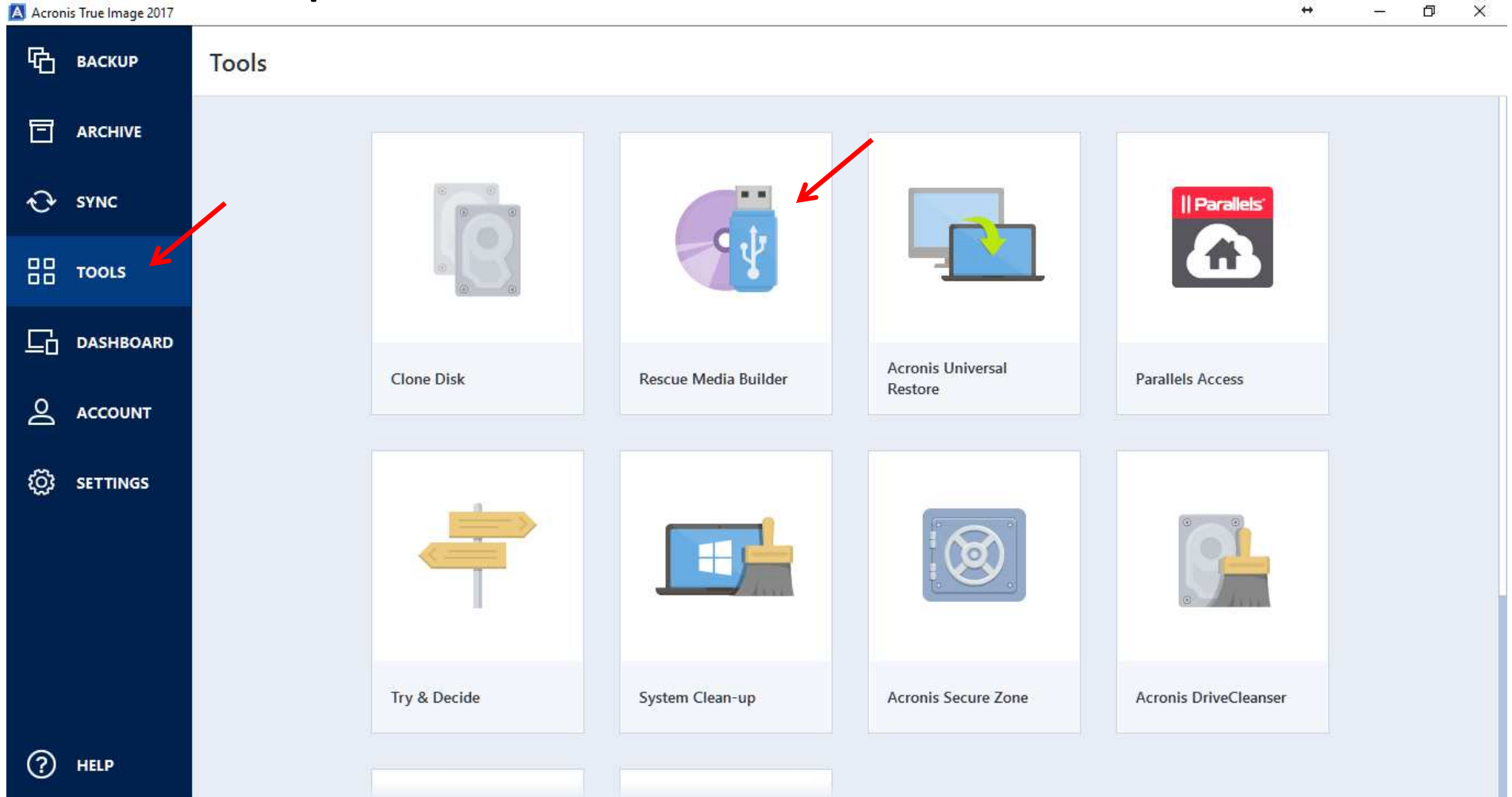

Select Acronis Bootable Rescue Media

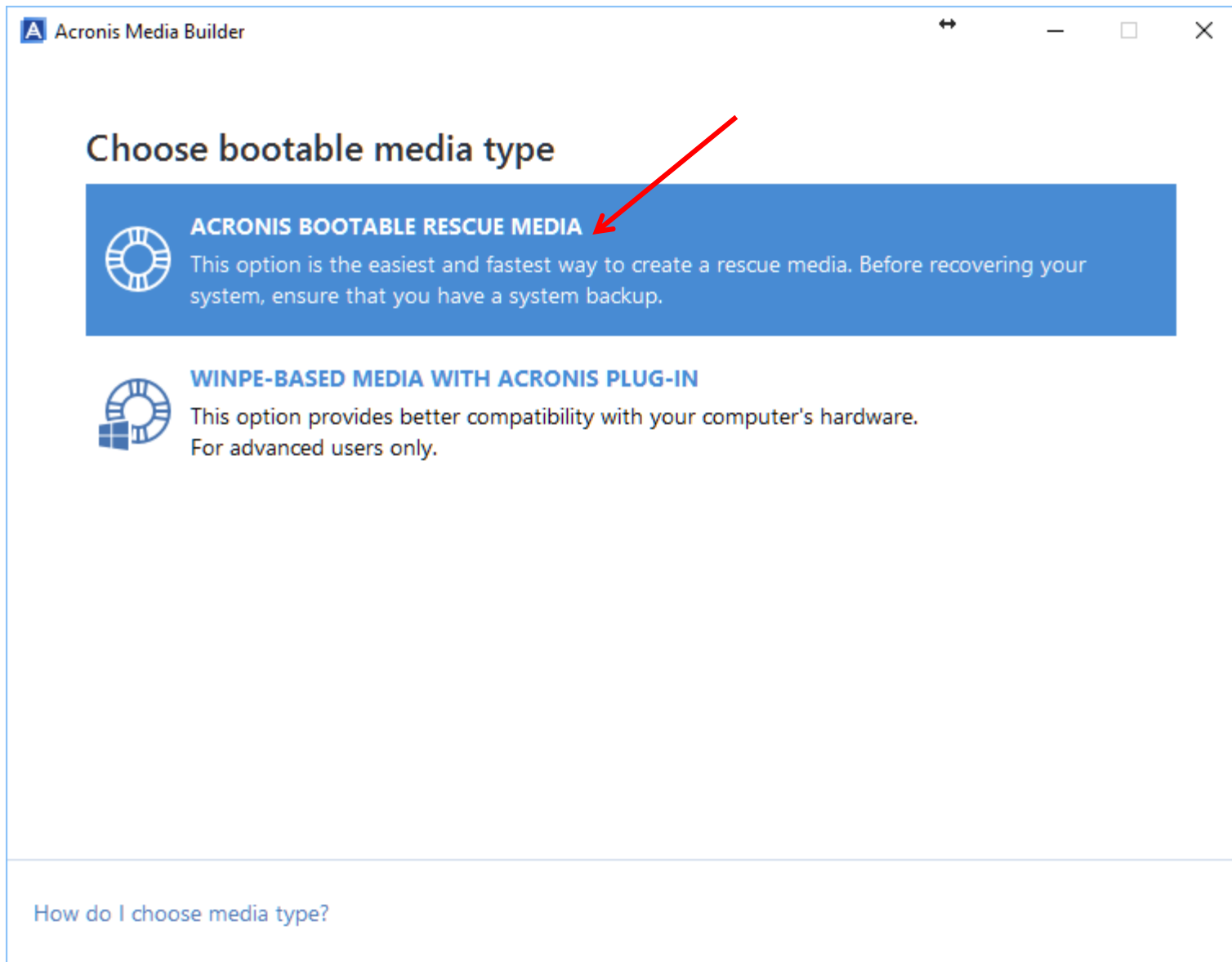

Select destination

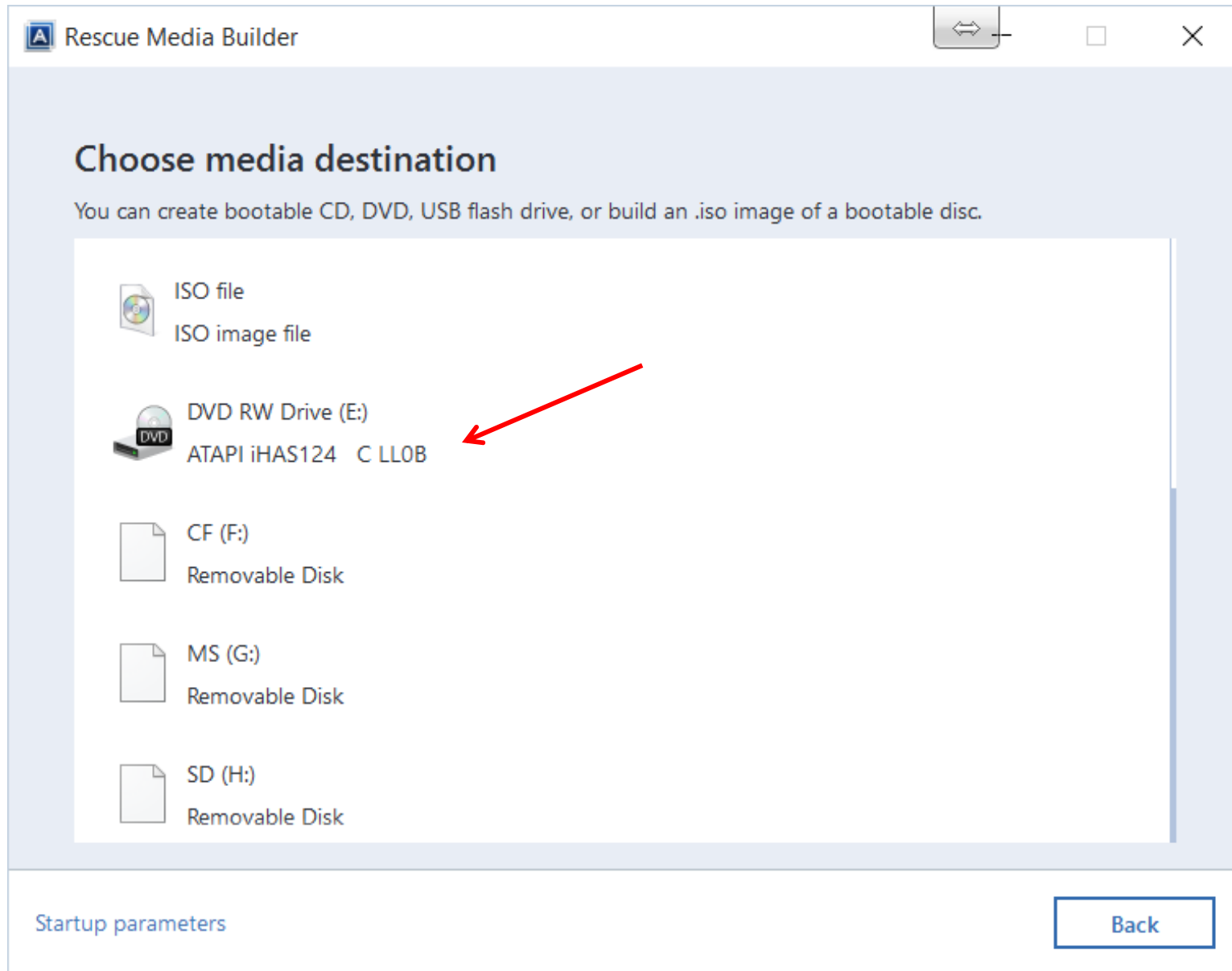

Click Proceed

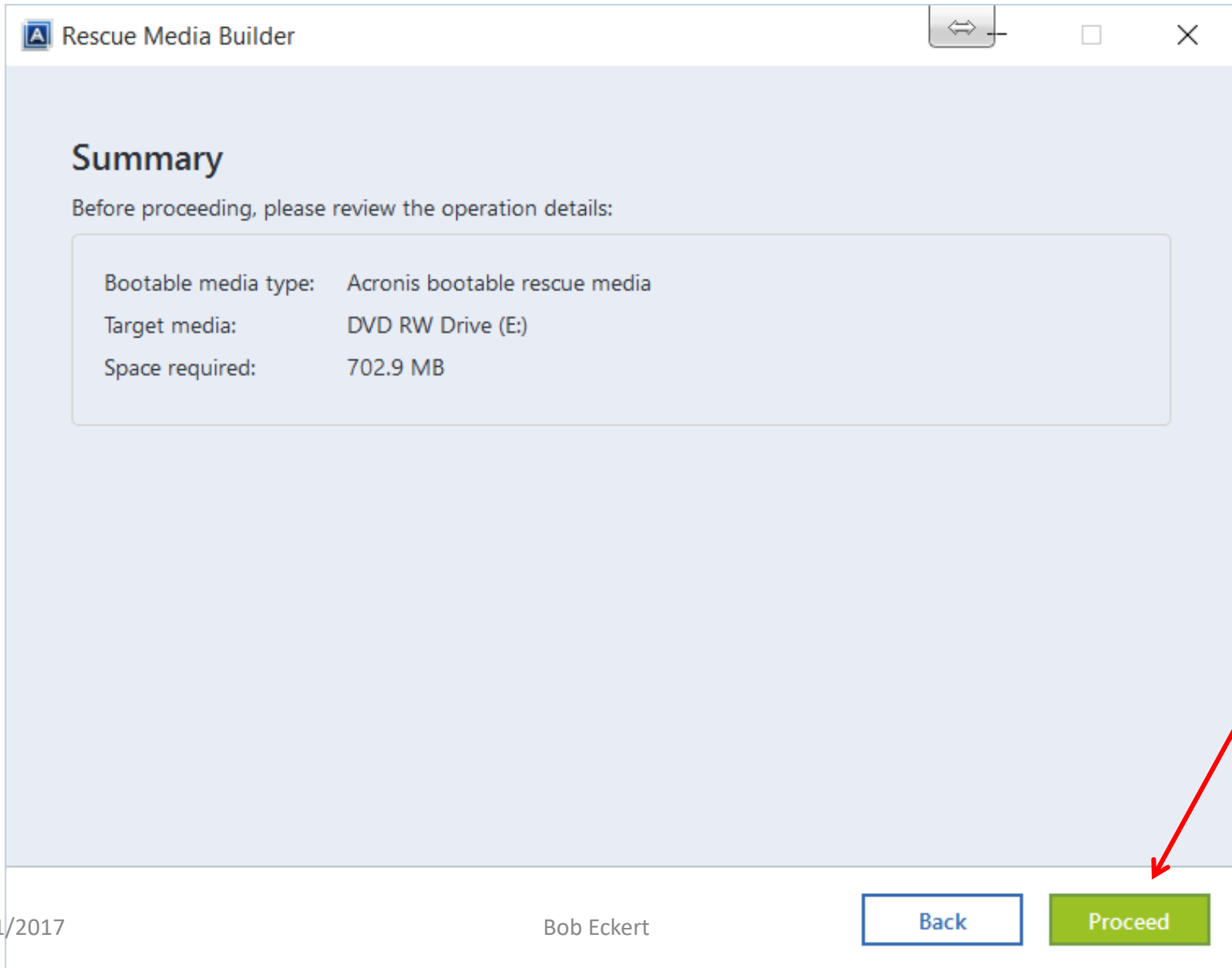

How to clone a disk

- For hard drive replacement / upgrade
- Connect new drive to SATA / USB adapter
- If using Apricorn DriveWire adapter, then can use their EZ Gig IV freeware
- EZ Gig IV is the drive cloning subset of Acronis True Image, and has a very similar user interface
- <http://www.apricorn.com/products/software/ezgig.html>

Example using Acronis True Image

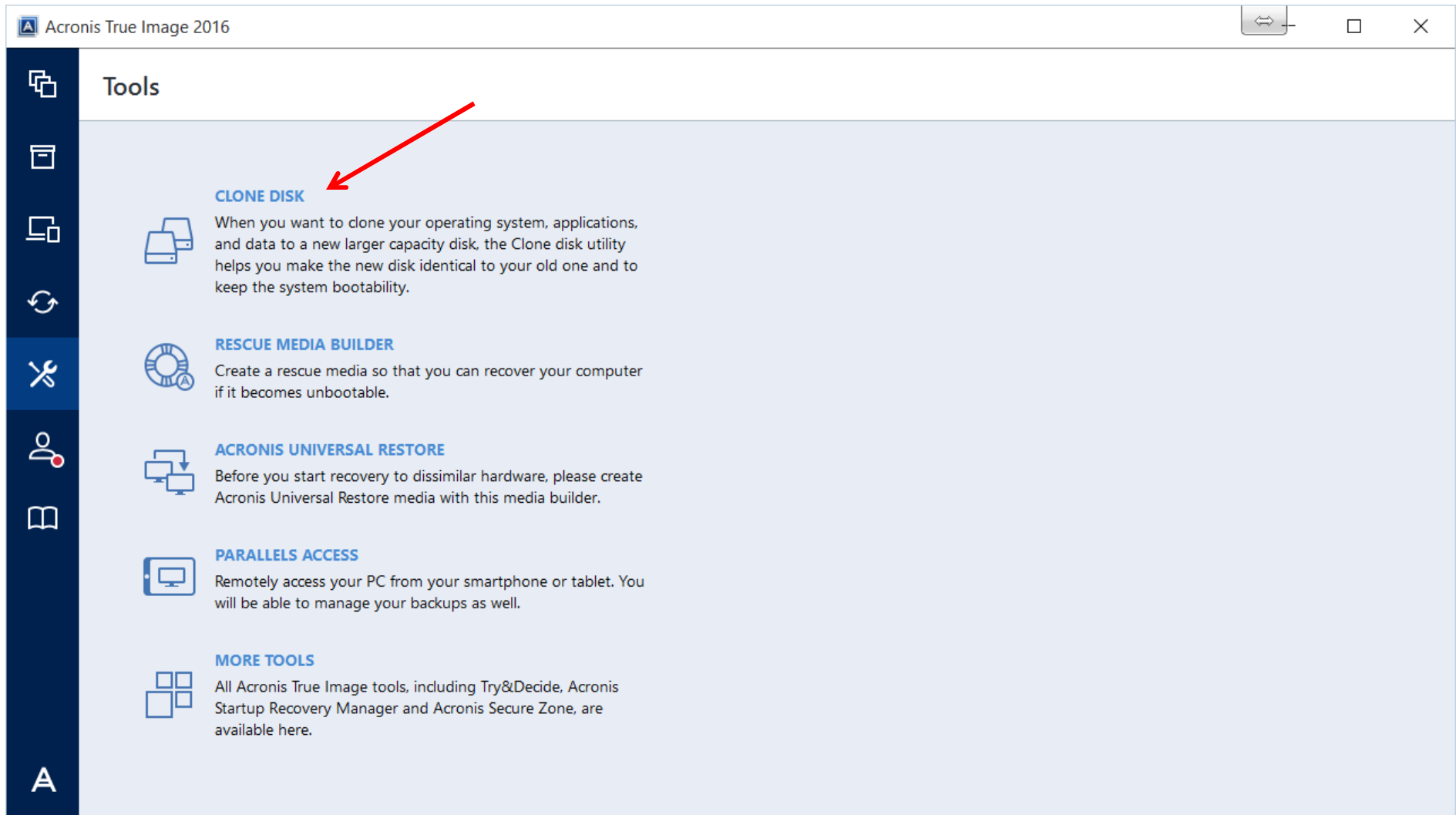

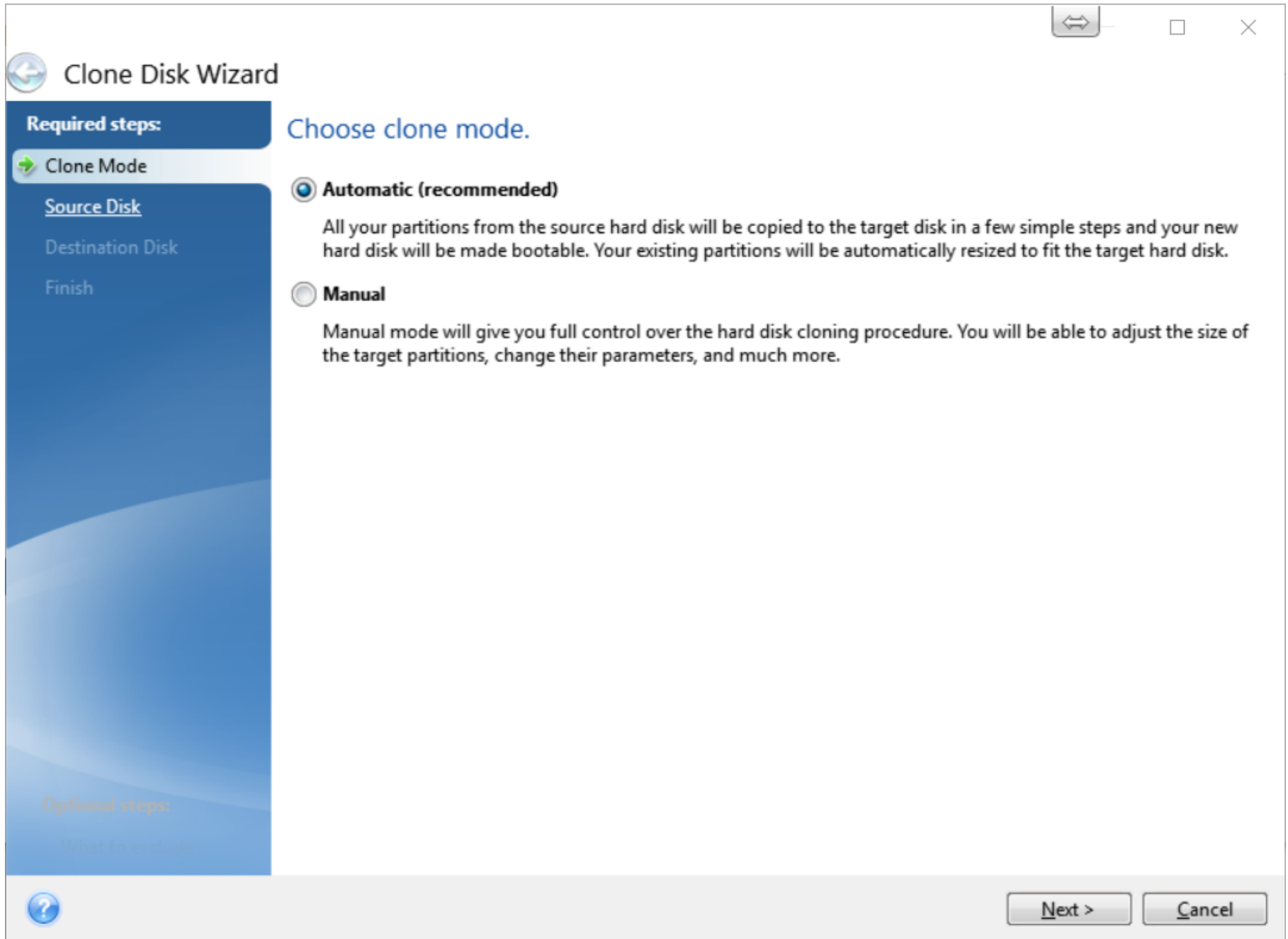

Clone Disk Wizard

Required steps:

- Clone Mode
- Source Disk
- Destination Disk
- Finish

Select the source hard disk from the list below.

Drive	Capacity	Model	Interface
Disk 1	238.5 GB	SAMSUNG SSD 830 Series	ATA(0) Primary Master
Disk 2	931.5 GB	WDC WD1002FAEX-00Y9A0	ATA(0) Primary Master
Disk 3	931.5 GB	WDC WD1003FZEX-00MK2A0	Serial ATA
Disk 9	465.8 GB	Seagate Portable 0130	USB

238.5 GB S... C: 237.9 GB NTFS

Primary // Logical // Dynamic Acronis Secure Zone Unallocated // Unsupported

Next > Cancel

Clone Disk Wizard

Required steps:

- ✓ Clone Mode
- ✓ Source Disk
- ➔ Destination Disk
- Finish

Select the target hard disk from the list below.

Drive	Capacity	Model	Interface
Disk 1	238.5 GB	SAMSUNG SSD 830 Series	ATA(0) Primary Master
Disk 2	931.5 GB	WDC WD1002FAEX-00Y9A0	ATA(0) Primary Master
Disk 3	931.5 GB	WDC WD1003FZEX-00MK2A0	Serial ATA
Disk 9	465.8 GB	Seagate Portable 0130	USB

465.8 GB L: 465.8 GB NTFS

Primary // Logical // Dynamic Acronis Secure Zone Unallocated // Unsupported

Next > Cancel

CAUTION!!!

- **At this point, make very sure that source and destination are correct!**
- **It is possible to erase your C:\ drive if you clone a blank disk to the C:\ drive!!!**

Final Steps

- Let the cloning run (20 minutes to a couple of hours depending on the amount of data and disk speed, a 256 GB SSD takes about 20 minutes, a larger spinning drive a couple of hours)
- Once the cloning is done, shut the PC down, disconnect power, remove laptop battery, swap drives, and reboot
- Your PC with the new drive will look just as it did before with all programs and files as they were.

Image file creation alternative

- Built in utility
- Buried in sub-sub menu of non-obvious location
- Reference:
 - <http://www.cnet.com/how-to/how-to-create-a-system-image-in-windows-10/>

Windows 10 Disk imaging utility

- 1. Open **Control Panel** and go to **File History**. (right click on start button and select Control Panel)

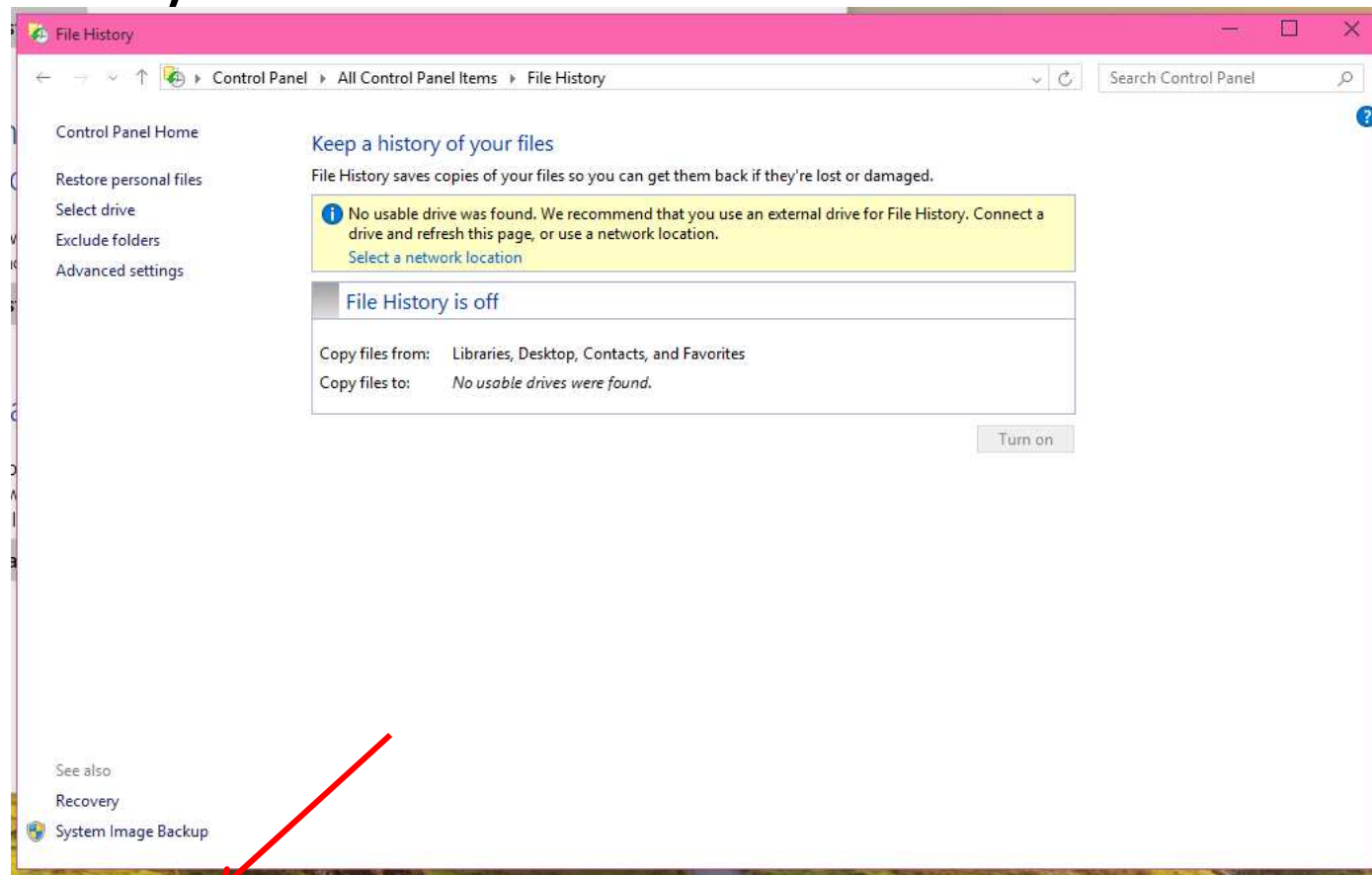

Windows 10 Disk imaging utility

- The System Image Backup utility will open. Pick a place to save your system image backup (on a hard disk, on one or more DVDs, or on a network location), and click **Next**. Confirm your settings and click **Start backup**.
- To use your system image to restore your PC, open up the new Windows 10 Settings menu and go to **Update & recovery**. Under **Recovery**, find the **Advanced startup** section, and click **Restart now**. When your PC restarts, go to **Troubleshoot, Advanced Options**, and then choose **System image recovery**.

Windows 10 Disk imaging utility

- If computer is unbootable, use Windows 10 install disk and follow these directions:
- <https://www.winhelp.us/restore-a-system-image-in-windows-7.html>
- The above link has directions for Windows 7, 8, and 10
- If doing this, DO NOT install, select “Troubleshoot”

This will lead to:



And then to:



You now have the opportunity to locate, select, and load the image file